

Make & Model

GMC SIERRA 2500/3500 15-UP 78.7", 97.6" LONG BED

INSTALLATION INSTRUCTION

Item No. 802-0123

(2 Different Style Available)

Pocket Style with Bolt & Nut (including Parts A.B.C)

Pocket Style with LED Light (including Parts A.B.D)

Parts A - Flares & Rubber Strip



Parts C - Parts for Bolt & Nut Style only (optional)



Parts B - Parts for Installation



Parts D - Parts for LED Light Style only (optional)



Caution: Always check the package & parts, ensure the fitment of flare and follow the instruction carefully. PSI will not be responsible for painting & orther cost incurred to incorrect fender flares, failure of installation, shipping damage and or any modified flares.

1. Pre-Installation



1. Prefit and ensure both left (driver) side & right (passenger) side fender flare to the vehicle before painting or installation.
2. You may remove any moldings, strips or existing flares from the vehicle for fitting and installation.

3. Clean Vehicle Body & Fender Flare

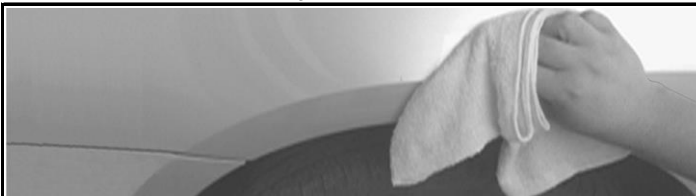

1. Wash and wipe dry the areas of contact on the vehicle body.
2. Clean the surface and inside edge of the fender flare where the rubber seal is to be attached.

2. Paint Flare(Optional)

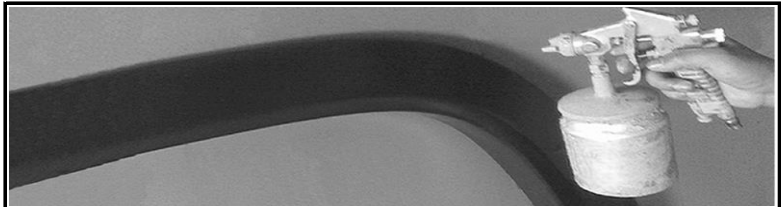

1. Hire a professional painter or body shop and follow the paint manufacturer specifiations to paint the flares.
2. Clean all fender flare surface with clean water & a mild detergent before paint, don't use lacquer thinner or any solvent based product

4. Apply Rubber Seal

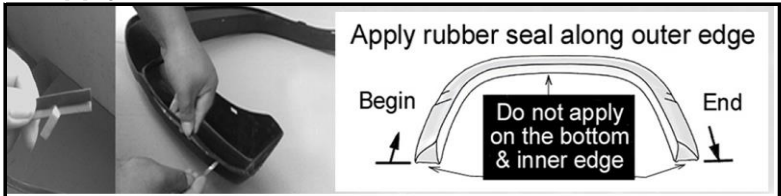

1. Remove 1 inch tape liner from rubber seal, apply it on the flare, start one end & along the edge that comes in contact with body panel. **Caution: 3M tape will stick on the inside of the flare.**
2. Make sure the rubber seal along the edge well, and rip the tape liner off gradually, apply pressure on the tape in the same time to ensure that it adheres well. Trim excess rubber seal and so on.

5. Install Allen Bolt & Nut (Pocket with Bolt Style)

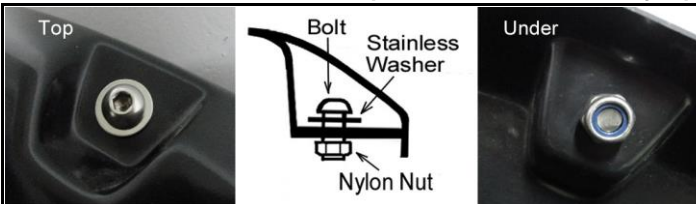

1. Use torx bit to tight allen bolt & nylon nut firmly on every pocket of the fender flares. **DO NOT OVER TIGHTEN !**
2. For Pocket with Bolt Style, skip 6,7,8, go step 9 directly.
3. For Pocket with Light Style, ignore step 5, go step 6 and on.

6. Install LED Light (Pocket with LED Light Style)

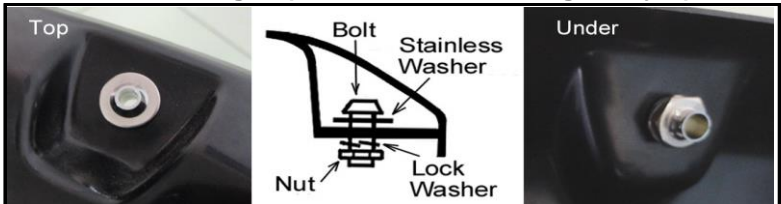

1. Tight LED Bolt, washer & nut with lock washer on every pocket of the flares. **ENSURE THE BOLTS ARE TIGHTEN ENOUGH !**

7. Install LED Light (Pocket with LED Light Style)

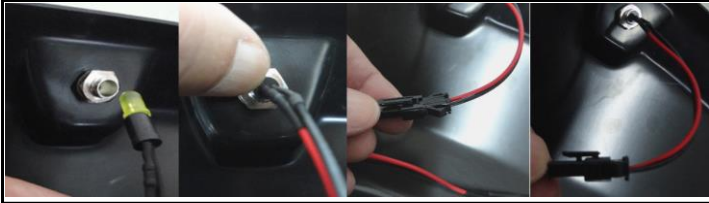

1. Insert the LED to the LED Bolt, push it into the end with nail **(see illustration)**. **DO NOT HOLD THE WIRE TO PUSH IT !**
2. To connect the connector, just push the clip side down on the female part and stoper side on the male part together.
3. To replace the LED if necessary, just push down the LED from **top side** & take it out. **DO NOT PULL OUT WITH WIRE**
4. To unplug the connector, just push down the clip end on the female part, pinch two side wing on the male part and pull straight out the male part.

9. Installation (Left Front Flare Shown)



1. Make sure the front tire has been turned to outward for easy installation.
2. **FOR MODELS WITH FACTORY MUDFLAP:**
Remove 5 mud flap fasteners with T-30, T-15 torx bit & screw driver. Save the upper two fasteners for re-install in step 11.

11. Installation (Left Front Flare Shown)

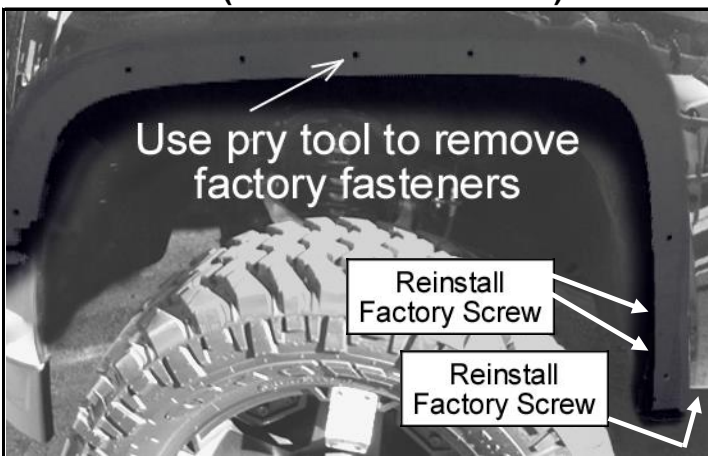

1. Pull the lower grip part to remove the factory wheel arch molding from vehicle.
2. Use pry tool to remove any remaining factory fasteners.
3. **FOR MODELS WITH FACTORY MUDFLAP:**
Re-install the upper two fasteners (removed in step 9-2).
4. Use a 1/2" socket to re-install fastener (removed in step 10-3) from the rear underside of factory wheel arch molding.

8. Install LED Light (Pocket with LED Light Style)

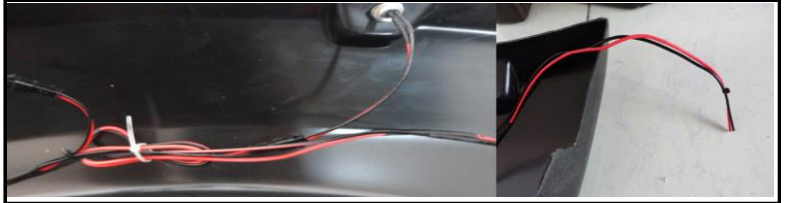

1. Tight the losing wire on the proper place.
2. The LED wire end should be toward to the front in the front flare, to the rear in the rear flare.
3. Use the extension wire **(NOT INCLUDED)** to connect LED wire and the parking light, turn signal light or orther electric source as your desire. If in doubt on the connection, get professional advice before connect it.
4. You may add a switch in between LED set and electric source to control it on and off easily.

10. Installation (Left Front Flare Shown)

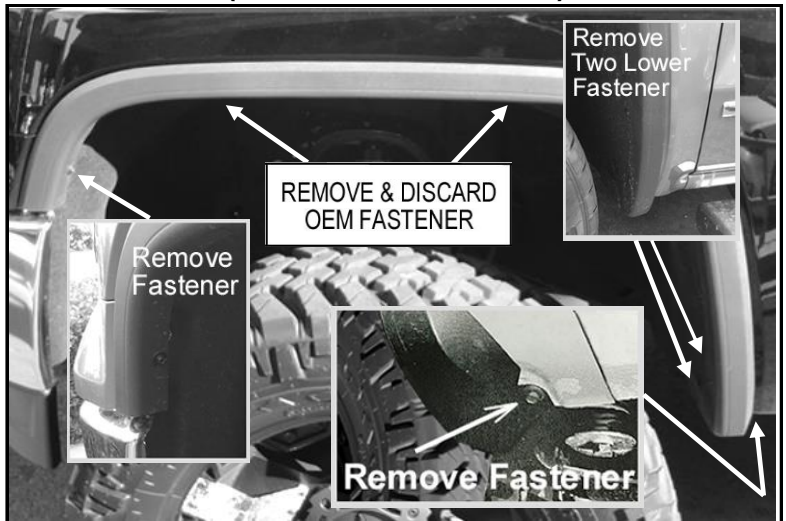

1. Use a 9/32" or 7mm socket to remove the fastener on the front of factory wheel arch molding.(left shown)
2. Use a T-15 Torx Bit to remove two lower fastener on the rear of factory wheel arch molding.(right top shown)
3. Use a 1/2" socket to remove fastener from the rear underside of factory wheel arch molding. Save and reinstallation.
4. Use a T-15 Torx Bit to remove two fastener along the top of factory wheel arch molding.(center top shown)

12. Installation (Left Front Flare Shown)

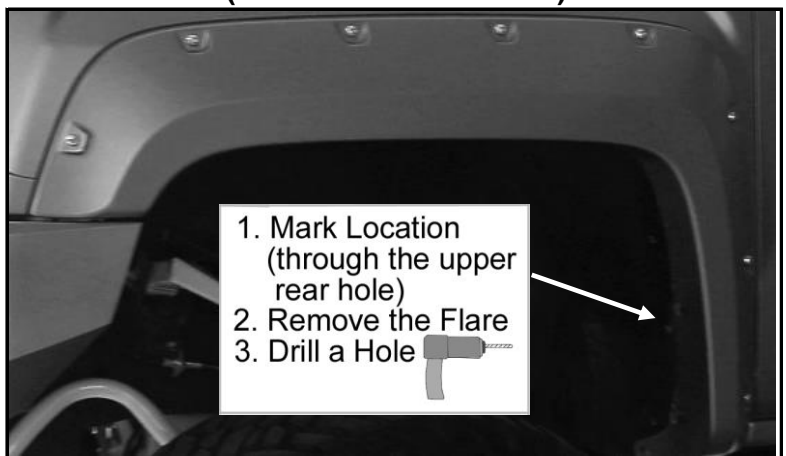

1. Hold the flare firmly on the fender, to confirm the right position.
2. **FOR MODELS WITHOUT FACTORY MUDFLAP:**
Make sure orther holes are on the position, use a grease pencil to mark a hole through the upper rear hole on the flare, as shown.
3. Remove the flare.
4. Drill a hole on the marked location through wheel well liner and sheet metal with a 3/32" drill bit.

13. Installation (Left Front Flare Shown)

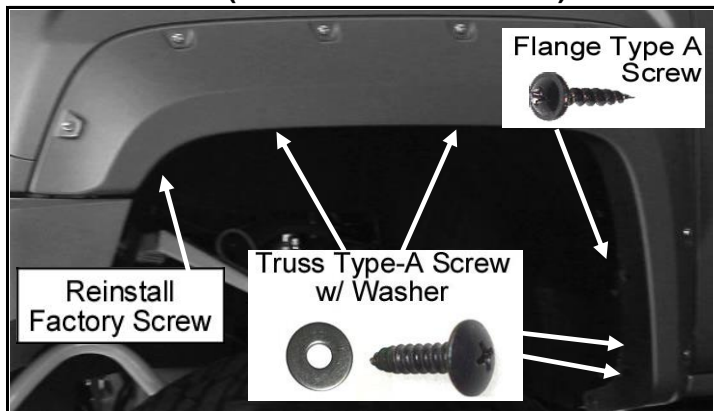

1. Install 4 supplied truss type A screws into the factory holes.
2. Re-install the factory screw, removed in step 10-1.
3. Install 1 supplied flange type A screw into the hole drilled.

15. Installation (Left Rear Flare Shown)

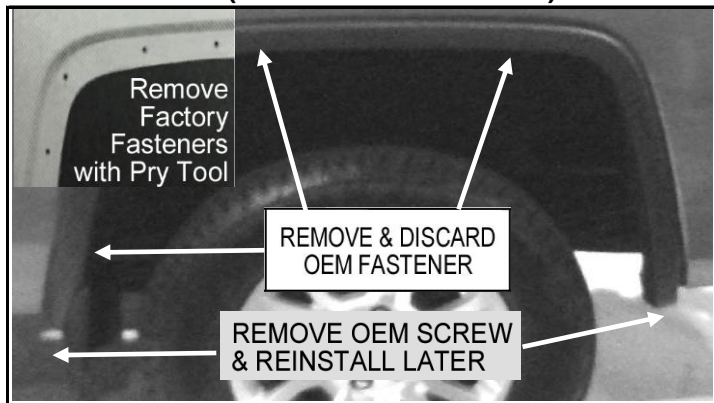

1. Use a 10mm socket to remove the lower 2 screws
2. use T-15 torx bit to remove the others 3 fastener.
3. Pull the lower grip part to remove the factory wheel arch molding from vehicle.
4. Use pry tool to remove any remaining factory fasteners.

17. Installation (Left Rear Flare Shown)

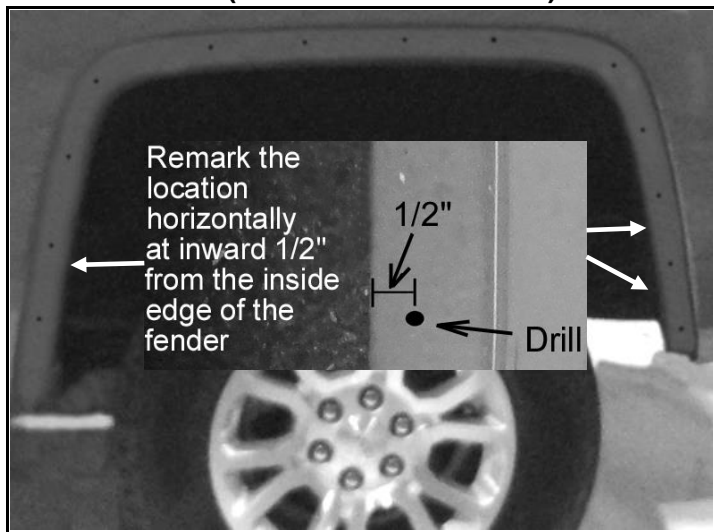

1. Remark the 3 locations (marked in step 16) horizontally at inward 1/2" from the inside edge of the fender.
2. Drill a hole on the marked locations through sheet metal with a 3/32" drill bit. (use a floor jack on the rear hitch to raise the truck bed for easy to drill)

Optional : You can use the included self tapping screws to secure the flare if need be.

14. Installation (Left Rear Flare Shown)

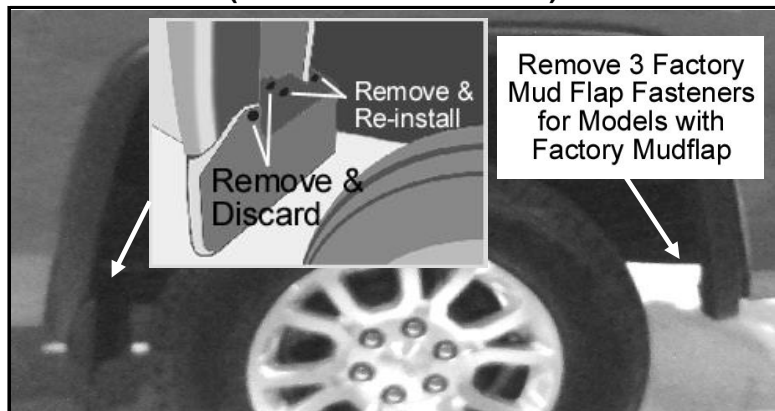

1. Remove 4 factory screws from the factory wheel well piece & remove.
 2. Re- install 2 factory screws into wheel well liner, as left shown.
- 2. FOR MODELS WITH FACTORY MUDFLAP:**
Remove 3 mud flap fasteners with screw driver.

16. Installation (Left Rear Flare Shown)



1. Hold the flare firmly on the fender, to confirm the right position.
2. Make sure orther holes are on the position, use a grease pencil to mark 3 holes through the holes on the flare, as shown.
3. Remove the flare.

18. Installation (Left Rear Flare Shown)

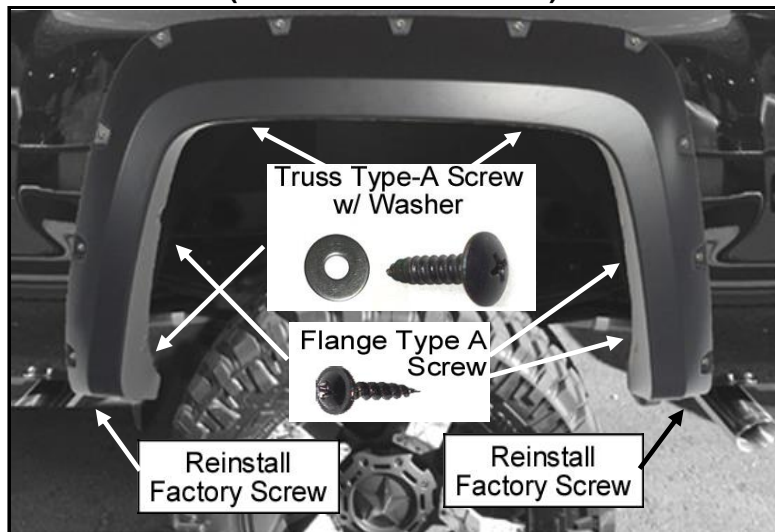

1. Install 3 supplied truss type A screws into the factory holes.
2. Re-install the 2 factory screws underside, removed in step 15.
3. Install 3 supplied flange type A screws into the holes drilled in step 17.

All rights reserved by Prime Selections, Inc. No part of this publication may be reproduced.

Prime Selections, Inc.· 5870 Ranchester Drive, Ste 650, Houston, TX 77036